

# APPLICATION FORM Main exhibitor

Please note that only fully-completed application forms can be processed.

Allocation of stand spaces will start in April 2018.



**FARBE, AUSBAU  
& FASSADE**

20. – 23. March 2019  
Cologne Exhibition Center

1

## CONTACT DETAILS

Please provide the following details as they appear in the commercial register.

**Customer number**  
(if available)

**VAT Reg. No.** – Country code/no.  
(Compulsory field – EU countries only)

Due to VAT legislation requirements, GHM Gesellschaft für Handwerksmessen mbH (GHM) is only able to issue invoices to its exhibitor = contracting partner or beneficiary its services.

**Company name including registered legal form**  
as in commercial register / Sole trader: last name, first name

Building no./street

Town/postcode

Country

Managing director  
(last name, first name)

☐ Ms  
☐ Mr

Contact person for (last name, first name)  
trade fair organisation

☐ Ms  
☐ Mr

Phone

Fax

Mobile

E-mail

Homepage

## Trade fair development through further contact (no stand construction company)

Company name as in commercial register /  
Sole trader: last name, first name

Building no./street

Town/postcode

Country

Contact person for (last name, first name)  
trade fair organisation

☐ Ms  
☐ Mr

Phone

Fax

Mobile

E-mail

2

## STAND DETAILS AND PRICES | We herewith order the following (excluding stand construction)

Size of stand (min. 12 m<sup>2</sup>):

Frontage

m

Depth

m

### Participation fee:

- |   |                          |   |                          |   |
|---|--------------------------|---|--------------------------|---|
| <input type="checkbox"/> Row stand* (1 side open)     | € 156.00 /m <sup>2</sup> | <input type="checkbox"/> End stand* (3 sides open)    | € 176.00 /m <sup>2</sup> | <input type="checkbox"/> Demonstration at stand |
| <input type="checkbox"/> Corner stand* (2 sides open) | € 167.00 /m <sup>2</sup> | <input type="checkbox"/> Island stand* (4 sides open) | € 181.00 /m <sup>2</sup> |   |
| <input type="checkbox"/> All-inclusive row stand**    | € 256.00 /m <sup>2</sup> | <input type="checkbox"/> All-inclusive corner stand** | € 267.00 /m <sup>2</sup> |   |

\* Stand excluding stand construction, \*\* Stand area including stand construction and special equipment (see separate information leaflet)

The full price will be charged for every square metre of space or part thereof. Any projecting elements, columns or joists are considered to be part of the area assigned.

### Additional costs:

- Media allowance for a compulsory entry in official media - e.g. catalogue - (online/print) of € 285.00. Please complete the form of our contractual partner. We cannot grant any price reduction if only parts of the package are used.
- AUMA fee of € 0.60 will be charged per square metre of rented space. As the umbrella organisation of the German trade fair industry, AUMA represents the interests of exhibitors, visitors and organisers and provides information and advice to all those involved in trade fairs from Germany and abroad.
- Flat-rate energy fee of € 7.50/m<sup>2</sup>
- MyBusiness premium allowance of € 10.50/m<sup>2</sup>
- Hall stands with an accessible upper floor will be subject to an additional fee of 50 % of the basic participation fee for the upper area.
- A co-exhibitor fee of € 380.00 will be charged for each co-exhibitor, which will be invoiced to the main exhibitor.

All prices indicated are net prices subject to the statutory rate of VAT applicable at the time the service is provided.

☐ Location if possible in the vicinity of:

☐ Location if possible **not** in the vicinity of:

Stand location will be decided  
by GHM. Exhibitors have no en-  
titlement to a specific location.

3

## CO-EXHIBITOR

☐ Registration is being made for co-exhibitors. Please complete an application form for each co-exhibitor.

4

**PRODUCT RANGE** This application form shall only be valid if submitted together with the enclosed **product range form** which needs to be filled in and **signed!**

Exhibition focus (required field):

Please refer to the enclosed product range for the appropriate term. Note: Data will not be automatically included in official media (catalogue etc.).

5

## DATA SECRECY STATEMENT

I am aware of the fact that my personal data will be processed and used by GHM Gesellschaft für Handwerksmessen mbH for customer support and contact purposes. I have the right to object to such use of my data at any time. Data will be used for contacting you by mail, phone, fax or e-mail. Should you not wish to be contacted by any of these means of communication, please send an e-mail with the corresponding instructions to [datenschutz@ghm.de](mailto:datenschutz@ghm.de).

## This is to register our participation and book the services listed above.

We have taken note of the Terms of Participation and other guidelines and by signing acknowledge their legally binding effect. We also consent to our company data being forwarded to service partners for the purpose of organising the fair.

We confirm that all services rendered by the service provider will be used for our company/co-exhibitor(s) and not for third-party or private purposes. This declaration will remain valid until revoked in writing.

Place/date

Company stamp/legally binding signature

# PRODUCT RANGE Main exhibitor

Please note that this application form is valid only if accompanied by a completed and signed product range.



**FARBE, AUSBAU  
& FASSADE**

20. – 23. March 2019  
Cologne Exhibition Center

**COMPANY NAME Main exhibitor**

Please classify your offer under the following branches of trade / products (please mark the applicable with an 'x').

## Coating materials, plastering, paints and varnishes

### 01. Mineral coatings

- ☐ 01.10.000 Silicate paints
- ☐ 01.11.000 Silicate emulsion paints
- ☐ 01.12.000 Silicone resin emulsion paints, silicone resin micro-emulsions
- ☐ 01.13.000 Structure coatings
- ☐ 01.14.000 Mineral plasters
- ☐ 01.15.000 Hydraulic fillers
- ☐ 01.16.000 Natural mineral colours

### 02. Emulsion-based coatings

- ☐ 02.10.000 Base coating materials for mineral substrates
- ☐ 02.11.000 Emulsion fillers
- ☐ 02.12.000 Washable, scrubbable emulsion paints
- ☐ 02.13.000 Paste emulsion paints
- ☐ 02.14.000 Filled emulsion paints
- ☐ 02.15.000 Weather-resistant emulsion paints
- ☐ 02.16.000 Emulsion-based coating systems for filling cracks
- ☐ 02.17.000 Tinting pigments for emulsion paints
- ☐ 02.18.000 Synthetic resin plaster
- ☐ 02.19.000 Sun-resistant paints

### 03. Oil, oil varnish and matt varnish paints

- ☐ 03.10.000 Base coating materials
- ☐ 03.11.000 Protective base coating materials for blueing
- ☐ 03.12.000 Protective base coating materials for wooden windows
- ☐ 03.13.000 Hard-drying oils
- ☐ 03.14.000 Linseed oils, varnishes, stand oils
- ☐ 03.15.000 Mixed-colour varnishes
- ☐ 03.16.000 Oil pastes (white and coloured pigment pastes)
- ☐ 03.17.000 Tinting colours for oil paints and oil varnish paints
- ☐ 03.18.000 Coating materials for corrosion protection
- ☐ 03.19.000 Matt varnish paints
- ☐ 03.20.000 Polymer resin paints that can be thinned with solvents

### 04. Varnishes / clear varnishes for indoors and outdoors

- ☐ 04.10.000 Alkyd varnishes
- ☐ 04.11.000 Acrylic varnishes
- ☐ 04.12.000 Nitrocellulose varnishes
- ☐ 04.13.000 Polyurethane varnishes
- ☐ 04.14.000 Epoxy varnishes
- ☐ 04.15.000 Polyester varnishes
- ☐ 04.16.000 Furniture varnishes
- ☐ 04.17.000 Outdoor furniture varnishes
- ☐ 04.18.000 Floor varnishes
- ☐ 04.19.000 Marine varnishes
- ☐ 04.20.000 Sun-resistant varnishes
- ☐ 04.21.000 Natural varnishes

### 05. Enamel paints

- ☐ 05.10.000 Base coating materials for enamel paints on mineral substrates
- ☐ 05.11.000 Base coating materials for enamel paint coatings on wood and derived timber products
- ☐ 05.12.000 Base coating materials for enamel paint coatings on steel, light metals, zinc and similar surfaces
- ☐ 05.13.000 Coating materials (impregnating coatings, high-build coatings)
- ☐ 05.14.000 Synthetic resin fillers
- ☐ 05.15.000 Alkyd enamel paints
- ☐ 05.16.000 Enamel paints for furniture
- ☐ 05.17.000 Enamel paints for floors
- ☐ 05.18.000 Tinting pigments for enamel paints
- ☐ 05.19.000 Enamel paints for radiators
- ☐ 05.20.000 Polyurethane enamel paints
- ☐ 05.21.000 Enamel paints for outdoor use

- ☐ 05.22.000 Window coating systems
- ☐ 05.23.000 Emulsion enamel paints
- ☐ 05.24.000 Epoxy resin enamel paints
- ☐ 05.25.000 Chlorinated rubber enamel paints
- ☐ 05.26.000 Multi-colour enamel effect paints
- ☐ 05.27.000 Enamel effect paints
- ☐ 05.28.000 Metallic pigment paints
- ☐ 05.29.000 Wood preservatives
- ☐ 05.30.000 Anti-corrosion coatings
- ☐ 05.31.000 Materials for flame-retardant coatings
- ☐ 05.32.000 Electrostatic flocking materials
- ☐ 05.33.000 Materials for renovating concrete
- ☐ 05.34.000 Roof-coating materials, protective paints for roofs
- ☐ 05.35.000 Natural varnish paints
- ☐ 05.36.000 Special coating materials
- ☐ 05.37.000 Conductive paints
- ☐ 05.38.000 Conductive coating materials
- ☐ 05.39.000 Thermotropic coating materials

### 06. Car repair paints

- ☐ 06.10.000 One and two-part primers
- ☐ 06.10.100 Nitrocellulose adhesive primers
- ☐ 06.10.200 Zinc chromate primers
- ☐ 06.10.300 Plastic adhesive primers
- ☐ 06.10.400 Wash primers
- ☐ 06.10.500 Reaction primers
- ☐ 06.10.600 Epoxy primers

### 06.11.000 Fillers

- ☐ 06.11.100 NC, NC combination fillers
- ☐ 06.11.200 Synthetic resin fillers
- ☐ 06.11.300 Polyethylene / polyester fillers
- ☐ 06.11.400 Polyethylene fibre plastics
- ☐ 06.11.500 Polyethylene-aluminium fillers
- ☐ 06.11.600 Polyethylene spraying plastics

### 06.12.000 One and two-part fillers

- ☐ 06.12.100 NC combination fillers
- ☐ 06.12.200 Wet-in-wet fillers
- ☐ 06.12.300 Reaction fillers
- ☐ 06.12.400 Epoxy priming fillers
- ☐ 06.12.500 Thick layer fillers
- ☐ 06.12.600 Polyurethane fillers (PU)
- ☐ 06.12.700 Transparent fillers

### 06.13.000 Top coats

- ☐ 06.13.100 Acrylic car paints
- ☐ 06.13.200 Metallic base coats (conventional)
- ☐ 06.13.300 Metallic base coats (aqueous)
- ☐ 06.13.400 Special effect paints
- ☐ 06.13.500 Structural paint coatings
- ☐ 06.13.600 Compact paints

### 06.14.000 Additives

- ☐ 06.14.100 Hardeners
- ☐ 06.14.200 Acrylic gloss additives
- ☐ 06.14.300 Acrylic converters
- ☐ 06.14.400 Activators
- ☐ 06.14.500 Additives for metallic base coats
- ☐ 06.14.600 Antisilicone additives
- ☐ 06.14.700 Matting agents
- ☐ 06.14.800 Flow control agents
- ☐ 06.14.900 Non-stop sealers

### 06.15.000 Thinners

### 06.16.000 Stone shield

- ☐ 06.16.100 Underbody protection
- ☐ 06.16.200 Cavity sealing



☐ **06.17.000 Paint removers**

- ☐ 06.17.100 Strippers
- ☐ 06.17.200 Paint strippers

☐ **06.18.000 Paint care products**

- ☐ 06.18.100 Polishes
- ☐ 06.18.200 Grinding pastes
- ☐ 06.18.300 Preservatives

**Thermal-insulating composite systems, seals, wall and floor coverings, wall papers, redevelopment and repair**

**07. Concrete repair**

- ☐ 07.10.000 Concrete protection
- ☐ 07.11.000 Concrete repair systems
- ☐ 07.12.000 Filling cracks in concrete
- ☐ 07.13.000 Tools and equipment for repairing concrete
- ☐ 07.14.000 Test and measurement equipment for repairing concrete
- ☐ 07.15.000 Renovating concrete

**08. Thermal-insulating composite systems**

- ☐ 08.10.000 Thermal-insulating composite systems
- ☐ 08.11.000 Additional materials for thermal-insulating composite systems
- ☐ 08.12.000 Tools and equipment for thermal-insulating composite systems
- ☐ 08.13.000 Sealants
- ☐ 08.14.000 Insulating materials
- ☐ 08.15.000 Facade construction materials

**09. Joint seals**

- ☐ 09.10.000 Joint fillers
- ☐ 09.11.000 Joint filling tapes
- ☐ 09.12.000 Foam sealant tapes
- ☐ 09.13.000 Sealing profile systems
- ☐ 09.14.000 Additives for joint sealing
- ☐ 09.15.000 Airtight construction work
- ☐ 09.16.000 Profiles, plaster lathing, fabrics
- ☐ 09.17.000 Protective materials
- ☐ 09.18.000 Dry-lining accessories

**10. Ceiling, wall and floor coverings and laying and coating systems**

- ☐ 10.10.000 Ceiling panels
- ☐ 10.11.000 Wall coverings in sheets
- ☐ 10.12.000 Wall panels, tiles
- ☐ 10.13.000 Floor coverings in panels and sheets
- ☐ 10.14.000 Carpets in panels and sheets
- ☐ 10.15.000 Floorboard levelling fillers
- ☐ 10.16.000 Floorboard coating systems
- ☐ 10.17.000 Carpet underlays
- ☐ 10.18.000 Insulating coverings
- ☐ 10.19.000 Solar protection foils
- ☐ 10.20.000 Liquid, dry and cement screeds
- ☐ 10.21.000 Lime, cement, ready-mix and renovation plasters
- ☐ 10.22.000 Gypsum plasters and plasterboards
- ☐ 10.23.000 Coving and decorating elements
- ☐ 10.24.000 Plaster profiles
- ☐ 10.25.000 Foundations and reinforcements for plasters
- ☐ 10.26.000 Fire protection constructions
- ☐ 10.26.100 Wall and ceiling structures
- ☐ 10.26.200 Dry lining, dry-lining systems
- ☐ 10.27.000 Strapping and mounting technology for ceilings and walls
- ☐ 10.28.000 Ceiling systems of plaster, mineral wool, metal and wood materials
- ☐ 10.29.000 Dry-lining systems for floors, walls, ceilings and facades

☐ 10.30.000 Sound insulating materials

- ☐ 10.31.000 Thermal-insulating systems and heat-insulating plasters
- ☐ 10.32.000 Calcium sulphate screeds
- ☐ 10.33.000 Fast screeds
- ☐ 10.34.000 Joint profiles for moving joints
- ☐ 10.35.000 Profiles for stair edges and tile coverings, balcony and terrace systems
- ☐ 10.36.000 Reinforcements from grid mats or fibres
- ☐ 10.37.000 Surface drainage from sheets or panels
- ☐ 10.38.000 Edge insulating strips
- ☐ 10.39.000 Decoupling sheets and plates
- ☐ 10.40.000 Building boards
- ☐ 10.41.000 Composite elements from polystyrene with mortar coating and fabric reinforcement
- ☐ 10.42.000 Footfall sound insulation
- ☐ 10.43.000 Mounting technology
- ☐ 10.44.000 Floors
- ☐ 10.44.100 Industrial flooring
- ☐ 10.44.200 Parquet
- ☐ 10.44.300 Laminate
- ☐ 10.45.000 Fire protection
- ☐ 10.46.000 Ceilings
- ☐ 10.47.000 Facade construction materials
- ☐ 10.48.000 Plaster and lime building materials
- ☐ 10.49.000 Cellar renovation, wall damp-proofing, footings
- ☐ 10.50.000 Natural stone, metal coverings, window sills
- ☐ 10.51.000 Plasters and plaster systems
- ☐ 10.52.000 Sound insulation, interior acoustics
- ☐ 10.53.000 Stucco, Acoustic plasters, acoustic coverings
- ☐ 10.54.000 Elastic surface coverings
- ☐ 10.55.000 Cork coverings

**11. Tile and panel-laying systems**

- ☐ 11.10.000 Composite seals from sheets, foils or liquid thin-bed mortar systems, cement, reaction resins, emulsions
- ☐ 11.11.000 Bond coats
- ☐ 11.12.000 Levelling fillers and fillers
- ☐ 11.13.000 Primers
- ☐ 11.14.000 Joint mortar, cement, reaction resins, emulsions
- ☐ 11.15.000 Adhesives
- ☐ 11.16.000 Impregnation, care and sealing materials, cleaning systems
- ☐ 11.17.000 Tiles and natural stones

**12. Tiles and panels**

- ☐ 12.10.000 Ceramic tiles and panels
- ☐ 12.11.000 Mosaics
- ☐ 12.12.000 Natural shaped stone
- ☐ 12.13.000 Glass tiles
- ☐ 12.14.000 Artificial stone
- ☐ 12.15.000 Bordures / listelli
- ☐ 12.16.000 Glass bricks
- ☐ 12.17.000 Clinker
- ☐ 12.18.000 Skirting boards

**13. Preservation of historic buildings and monuments**

- ☐ 13.10.000 Restoration supplies
- ☐ 13.11.000 Pigments
- ☐ 13.12.000 Historical construction materials
- ☐ 13.13.000 Materials to replace stone
- ☐ 13.13.100 Stucco
- ☐ 13.14.000 Doors

**14. Illumination, controlled ventilation and extraction, building technology, surface heating systems, electric heating mats**

- ☐ 14.10.000 Wall heating systems
- ☐ 14.11.000 Ventilation systems



**15. Ecological construction materials**

- ☐ 15.10.000 Insulating materials
- ☐ 15.11.000 Clay materials
- ☐ 15.12.000 Wood products
- ☐ 15.13.000 Recycling materials
- ☐ 15.14.000 Tile materials
- ☐ 15.15.000 Floor coverings
- ☐ 15.16.000 Plaster mortars

**16. Wall coverings, wallpapers, special wallpapers, stretch fabrics and decorations**

- ☐ 16.10.000 Wallpapers (wet and dry finishable)
- ☐ 16.11.000 Woodchip and embossed wallpapers, unprinted
- ☐ 16.12.000 Special wallpapers
- ☐ 16.13.000 Plastic-coated carriers
- ☐ 16.14.000 Materials for wallpaper underlay
- ☐ 16.15.000 Underpapers with smoothing effect
- ☐ 16.16.000 Insulating foils
- ☐ 16.17.000 Stretch fabrics
- ☐ 16.18.000 Heat insulating materials (internal)
- ☐ 16.19.000 Wall fillers
- ☐ 16.20.000 Surface techniques

**Tools, spraying systems and equipment, adhesive and auxiliary materials**

**17. Adhesives**

- ☐ 17.10.000 Wallpaper pastes
- ☐ 17.11.000 Special pastes
- ☐ 17.12.000 Adhesives for ceiling and wall coverings
- ☐ 17.13.000 Adhesives for floor coverings
- ☐ 17.14.000 Adhesives for ceramic tiles
- ☐ 17.15.000 Adhesives for flocking

**18. Auxiliary materials**

- ☐ 18.10.000 Strippers and stripping materials
- ☐ 18.11.000 Fluates
- ☐ 18.12.000 Blocking materials
- ☐ 18.13.000 Degreasing agents
- ☐ 18.14.000 Phosphatizing materials
- ☐ 18.15.000 Solvents, thinners and cleaning agents
- ☐ 18.16.000 Wood protection materials
- ☐ 18.17.000 Impregnating materials
- ☐ 18.18.000 Water-repellent materials (hydrophobic agents)
- ☐ 18.19.000 Fillers
- ☐ 18.20.000 Insulating materials
- ☐ 18.21.000 Corner protection rails
- ☐ 18.22.000 Reinforcing materials and fabrics
- ☐ 18.23.000 Brush cleaners
- ☐ 18.24.000 Wallpaper releasers
- ☐ 18.25.000 Insulating materials (vapour barriers)
- ☐ 18.26.000 foils, papers, protective foils, protective sheets, protective grids
- ☐ 18.27.000 Masking tapes
- ☐ 18.28.000 Marking tapes
- ☐ 18.29.000 Abrasive papers and materials
- ☐ 18.30.000 Polishing materials

**19. Paint spraying equipment and systems**

- ☐ 19.10.000 Low-pressure spraying equipment
- ☐ 19.11.000 High-pressure spraying equipment
- ☐ 19.12.000 Airless spraying equipment
- ☐ 19.13.000 Hot-spraying equipment
- ☐ 19.14.000 Electrostatic spraying equipment
- ☐ 19.15.000 Spraying guns
- ☐ 19.16.000 Accessories for spray equipment / guns
- ☐ 19.17.000 Compressors
- ☐ 19.18.000 Spraying and drying systems

- ☐ 19.19.000 Spraying cabins, combination cabins, drying cabins
- ☐ 19.20.000 Small painting systems
- ☐ 19.21.000 Dip painting systems
- ☐ 19.22.000 Powder coatings
- ☐ 19.23.000 Flocking
- ☐ 19.24.000 Paint mist extraction systems, spray booths, spraying walls
- ☐ 19.25.000 Multi-component spray equipment

**20. Tools, equipment and machines**

- ☐ 20.10.000 Paintbrushes and brushes
- ☐ 20.11.000 Paint rollers
- ☐ 20.12.000 Painting tools
- ☐ 20.13.000 Wallpapering tools and tables
- ☐ 20.14.000 Devices for rolling up broad wallpaper with counter and cutting device
- ☐ 20.15.000 Floor tiling tools
- ☐ 20.16.000 Tools and equipment for cutting insulating boards and reinforcing fabrics
- ☐ 20.17.000 Tools for painting vehicles
- ☐ 20.18.000 Gilding tools
- ☐ 20.19.000 Grinding and polishing machines
- ☐ 20.20.000 Jet blowers
- ☐ 20.21.000 Stirring apparatus and pumps (solvent pumps)
- ☐ 20.22.000 Flood systems
- ☐ 20.23.000 Immersion systems
- ☐ 20.24.000 Tools for laying tiles
- ☐ 20.25.000 Equipment for gluing wallpaper
- ☐ 20.26.000 Flame cleaning devices
- ☐ 20.27.000 Steam and hot water devices
- ☐ 20.28.000 Cement spraying devices
- ☐ 20.29.000 Spray pump equipment
- ☐ 20.30.000 Tools for gluing wall tiles
- ☐ 20.31.000 Electrostatic flocking devices
- ☐ 20.32.000 Testing and measuring equipment for coatings and bases
- ☐ 20.33.000 Paint mixing equipment
- ☐ 20.34.000 Cutting equipment
- ☐ 20.35.000 Tools for surface design
- ☐ 20.36.000 High-pressure cleaning equipment
- ☐ 20.37.000 Equipment for building sites
- ☐ 20.38.000 Home / office containers
- ☐ 20.39.000 Toilets
- ☐ 20.40.000 Shower cabins
- ☐ 20.41.000 Recreation rooms
- ☐ 20.42.000 Tools for surface finishing
- ☐ 20.43.000 Chisel hammers
- ☐ 20.44.000 Needle guns
- ☐ 20.45.000 Air conditioning systems
- ☐ 20.46.000 Air humidifiers and dehumidifiers
- ☐ 20.47.000 Heating units
- ☐ 20.48.000 Compressed air tools
- ☐ 20.49.000 Filter materials
- ☐ 20.50.000 devices, carpet cleaning devices, vacuum cleaners
- ☐ 20.51.000 Corrosion protection / cleaning / processing
- ☐ 20.52.000 Machines and equipment for dry lining and assembly
- ☐ 20.53.000 Processing machines for plasters and flooring, conveying equipment
- ☐ 20.54.000 Tile-cutting and polishing tools
- ☐ 20.55.000 Screed pumps
- ☐ 20.56.000 Measuring instruments
- ☐ 20.57.000 Sand-blasting and mortar machines
- ☐ 20.58.000 Waste water disposal and treatment
- ☐ 20.59.000 Industrial vacuum cleaners
- ☐ 20.60.000 Sawing, milling etc.
- ☐ 20.61.000 Slab-cutters
- ☐ 20.62.000 Tools



### **Ladders and scaffolding, occupational safety**

#### **21. Ladders and scaffolding**

- ☐ 21.10.000 Ladders
- ☐ 21.11.000 Trestles and horses
- ☐ 21.12.000 Erecting decks
- ☐ 21.13.000 Elevating erecting decks, sky lifts
- ☐ 21.14.000 Scaffolding
- ☐ 21.15.000 Construction site logistics, vehicles
- ☐ 21.16.000 Scaffolding and ladders

#### **22. Devices and equipment for environmental protection and workshops**

- ☐ 22.10.000 Waste-water collection systems
- ☐ 22.11.000 Waste-water processing
- ☐ 22.12.000 Waste-air purification plants
- ☐ 22.13.000 Disposal of varnish and paint residues, waste, residual materials
- ☐ 22.14.000 Collection containers
- ☐ 22.15.000 Collection and disposal containers
- ☐ 22.16.000 Catchment basins
- ☐ 22.17.000 Recycling systems for solvents

#### **23. Occupational safety**

- ☐ 23.10.000 Safety clothing, protective wear
- ☐ 23.11.000 Breathing masks
- ☐ 23.12.000 Skin and personal protective equipment
- ☐ 23.13.000 Information, warning and prohibitive signs
- ☐ 23.14.000 Protective clothing, occupational safety

### **Lettering, gilding, IT, trade media, miscellaneous**

#### **24. Lettering / signage, screen printing, gilding**

- ☐ 24.10.000 Finished letters
- ☐ 24.11.000 Stamp sets
- ☐ 24.12.000 Self-adhesive letters
- ☐ 24.13.000 Cutting foils, adhesive tapes
- ☐ 24.14.000 Screen printing equipment
- ☐ 24.15.000 Screen printing systems
- ☐ 24.16.000 Light and phototypesetting equipment
- ☐ 24.17.000 Screen printing inks
- ☐ 24.18.000 Glass paints
- ☐ 24.19.000 Gold leaf, silver leaf, metal leaf
- ☐ 24.20.000 Bronze paints, bronzes, mixtion

#### **25. Information technology**

- ☐ 25.10.000 Hardware
- ☐ 25.11.000 Software
- ☐ 25.12.000 Consulting
- ☐ 25.13.000 Computers for colour design
- ☐ 25.14.000 Software for colour design
- ☐ 25.15.000 Bathroom planning software
- ☐ 25.16.000 Building site computers
- ☐ 25.17.000 IT, office organisation, communication

#### **26. Miscellaneous and trade media**

- ☐ 26.10.000 Artists' paints, all types of painting and drawing utensils
- ☐ 26.11.000 Technical books
- ☐ 26.12.000 Trade publications
- ☐ 26.13.000 Colour swatches
- ☐ 26.14.000 Work clothing
- ☐ 26.15.000 Office organisation, office furnishing
- ☐ 26.16.000 Trim foils, self-adhesive foils
- ☐ 26.17.000 Carpet trim and rods
- ☐ 26.18.000 Decorative strips, ornamental profiles, decorative rosettes, ornaments and similar products
- ☐ 26.19.000 Door frame seals, all types of skirting boards, panels and sawn timber
- ☐ 26.20.000 Advertising and sales stands
- ☐ 26.21.000 Fittings for specialist paint shops
- ☐ 26.22.000 Workshop fittings
- ☐ 26.23.000 Store fittings
- ☐ 26.24.000 Services
- ☐ 26.25.000 Presentation systems for wall and floor coverings
- ☐ 26.26.000 Barrier-free construction
- ☐ 26.27.000 Entrance areas, staircases
- ☐ 26.28.000 Financing
- ☐ 26.29.000 Franchise systems
- ☐ 26.30.000 First-hand planning
- ☐ 26.31.000 Publishers, associations, institutions
- ☐ 26.32.000 Further training
- ☐ 26.33.000 Edit formats, accessories, auxiliary materials
- ☐ 26.34.000 Cleaning and maintenance products for elastic, textile, laminate, parquet, cork coverings
- ☐ 26.35.000 Graffiti removal and protection



Please note that this information is not published automatically in the official media. You will be contacted in due time by our service provider for information to be listed in the official media.



**The product range is an integral part of the application form.**  
Please return the product range form to us together with the application form.

Place/date

Company stamp/legally binding signature

# APPLICATION FORM Co-exhibitor (to be filled in by main exhibitor!)

Please note that only fully completed application forms can be processed  
Allocation of stand spaces will start in April 2018.



**FARBE, AUSBAU  
& FASSADE**

20. – 23. March 2019  
Cologne Exhibition Center

1

## COMPANY NAME Main exhibitor

As main exhibitor we herewith register our co-exhibitor, who will be represented with its own staff and exhibit its own products and services in accordance with the Terms of Participation. An application form must be completed for each co-exhibitor.

2

## CONTACT DETAILS Co-exhibitor

Please provide the following details as they appear in the commercial register.

**VAT Reg. No.** - Country code/no.  
(Compulsory field - EU countries only)

Due to VAT legislation requirements, GHM Gesellschaft für Handwerksmessen mbH (GHM) is only able to issue invoices to its exhibitor = contracting partner or beneficiary for its services.

**Company name including registered legal form**  
as in commercial register / Sole trader: last name, first name

Building no./street

Town/postcode

Country

Managing director  
(last name, first name)

☐ Ms  
☐ Mr

Homepage

Contact person for (last name, first name)  
trade fair organisation

☐ Ms  
☐ Mr

Phone

Fax

Mobile

E-mail

3

## PRICES

A fee of € 380.00 plus VAT will be charged for each co-exhibitor. The fee and any other incidental services will be invoiced to the main exhibitor. The main exhibitor is as such the party liable towards GHM. Should GHM invoice the co-exhibitor for services provided, the main exhibitor will in all cases bear joint and several liability towards GHM.

Extras:

Media allowance for a compulsory entry in official media - e.g. catalogue - (online/print) of € 285.00.

Please complete the form of our contractual partner. We cannot grant any price reduction if only parts of the package are used.

All prices indicated are net prices subject to the statutory rate of VAT applicable at the time the service is provided.

4

**PRODUCT RANGE** This application form shall only be valid if submitted together with the enclosed **product range form** which needs to be filled in and signed!

Exhibition focus (required field):

Please refer to the enclosed product range for the appropriate term. Note: Data will not be automatically included in official media (catalogue etc.).

5

## DATA SECRECY STATEMENT

I am aware of the fact that my personal data will be processed and used by GHM Gesellschaft für Handwerksmessen mbH for customer support and contact purposes. I have the right to object to such use of my data at any time. Data will be used for contacting you by mail, phone, fax or e-mail. Should you not wish to be contacted by any of these means of communication, please send an e-mail with the corresponding instructions to [datenschutz@ghm.de](mailto:datenschutz@ghm.de).

**This is to register our co-exhibitor's participation and book the services listed above.** We have taken note of the Terms of Participation and other guidelines and by signing acknowledge their legally binding effect. We also consent to our company data being forwarded to service partners for the purpose of organising the fair.

We confirm that all services rendered by the service provider will be used for our company/co-exhibitor(s) and not for third-party or private purposes. This declaration will remain valid until revoked in writing.

Place/date

Company stamp/legally binding signature



# PRODUCT RANGE Co-exhibitor

Please note that this application form is valid only if accompanied by a completed and signed product range.



**FARBE, AUSBAU  
& FASSADE**

20. – 23. March 2019  
Cologne Exhibition Center

**COMPANY NAME Main exhibitor**

**COMPANY NAME Co-exhibitor**

Our co-exhibitor is active in the following industries/offers the following products (please tick off if applicable):

## Coating materials, plastering, paints and varnishes

### 01. Mineral coatings

- ☐ 01.10.000 Silicate paints
- ☐ 01.11.000 Silicate emulsion paints
- ☐ 01.12.000 Silicone resin emulsion paints, silicone resin micro-emulsions
- ☐ 01.13.000 Structure coatings
- ☐ 01.14.000 Mineral plasters
- ☐ 01.15.000 Hydraulic fillers
- ☐ 01.16.000 Natural mineral colours

### 02. Emulsion-based coatings

- ☐ 02.10.000 Base coating materials for mineral substrates
- ☐ 02.11.000 Emulsion fillers
- ☐ 02.12.000 Washable, scrubable emulsion paints
- ☐ 02.13.000 Paste emulsion paints
- ☐ 02.14.000 Filled emulsion paints
- ☐ 02.15.000 Weather-resistant emulsion paints
- ☐ 02.16.000 Emulsion-based coating systems for filling cracks
- ☐ 02.17.000 Tinting pigments for emulsion paints
- ☐ 02.18.000 Synthetic resin plaster
- ☐ 02.19.000 Sun-resistant paints

### 03. Oil, oil varnish and matt varnish paints

- ☐ 03.10.000 Base coating materials
- ☐ 03.11.000 Protective base coating materials for blueing
- ☐ 03.12.000 Protective base coating materials for wooden windows
- ☐ 03.13.000 Hard-drying oils
- ☐ 03.14.000 Linseed oils, varnishes, stand oils
- ☐ 03.15.000 Mixed-colour varnishes
- ☐ 03.16.000 Oil pastes (white and coloured pigment pastes)
- ☐ 03.17.000 Tinting colours for oil paints and oil varnish paints
- ☐ 03.18.000 Coating materials for corrosion protection
- ☐ 03.19.000 Matt varnish paints
- ☐ 03.20.000 Polymer resin paints that can be thinned with solvents

### 04. Varnishes / clear varnishes for indoors and outdoors

- ☐ 04.10.000 Alkyd varnishes
- ☐ 04.11.000 Acrylic varnishes
- ☐ 04.12.000 Nitrocellulose varnishes
- ☐ 04.13.000 Polyurethane varnishes
- ☐ 04.14.000 Epoxy varnishes
- ☐ 04.15.000 Polyester varnishes
- ☐ 04.16.000 Furniture varnishes
- ☐ 04.17.000 Outdoor furniture varnishes
- ☐ 04.18.000 Floor varnishes
- ☐ 04.19.000 Marine varnishes
- ☐ 04.20.000 Sun-resistant varnishes
- ☐ 04.21.000 Natural varnishes

### 05. Enamel paints

- ☐ 05.10.000 Base coating materials for enamel paints on mineral substrates
- ☐ 05.11.000 Base coating materials for enamel paint coatings on wood and derived timber products
- ☐ 05.12.000 Base coating materials for enamel paint coatings on steel, light metals, zinc and similar surfaces
- ☐ 05.13.000 Coating materials (impregnating coatings, high-build coatings)
- ☐ 05.14.000 Synthetic resin fillers
- ☐ 05.15.000 Alkyd enamel paints
- ☐ 05.16.000 Enamel paints for furniture
- ☐ 05.17.000 Enamel paints for floors
- ☐ 05.18.000 Tinting pigments for enamel paints
- ☐ 05.19.000 Enamel paints for radiators

- ☐ 05.20.000 Polyurethane enamel paints
- ☐ 05.21.000 Enamel paints for outdoor use
- ☐ 05.22.000 Window coating systems
- ☐ 05.23.000 Emulsion enamel paints
- ☐ 05.24.000 Epoxy resin enamel paints
- ☐ 05.25.000 Chlorinated rubber enamel paints
- ☐ 05.26.000 Multi-colour enamel effect paints
- ☐ 05.27.000 Enamel effect paints
- ☐ 05.28.000 Metallic pigment paints
- ☐ 05.29.000 Wood preservatives
- ☐ 05.30.000 Anti-corrosion coatings
- ☐ 05.31.000 Materials for flame-retardant coatings
- ☐ 05.32.000 Electrostatic flocking materials
- ☐ 05.33.000 Materials for renovating concrete
- ☐ 05.34.000 Roof-coating materials, protective paints for roofs
- ☐ 05.35.000 Natural varnish paints
- ☐ 05.36.000 Special coating materials
- ☐ 05.37.000 Conductive paints
- ☐ 05.38.000 Conductive coating materials
- ☐ 05.39.000 Thermotropic coating materials

### 06. Car repair paints

- ☐ 06.10.000 One and two-part primers
- ☐ 06.10.100 Nitrocellulose adhesive primers
- ☐ 06.10.200 Zinc chromate primers
- ☐ 06.10.300 Plastic adhesive primers
- ☐ 06.10.400 Wash primers
- ☐ 06.10.500 Reaction primers
- ☐ 06.10.600 Epoxy primers

### 06.11.000 Fillers

- ☐ 06.11.100 NC, NC combination fillers
- ☐ 06.11.200 Synthetic resin fillers
- ☐ 06.11.300 Polyethylene / polyester fillers
- ☐ 06.11.400 Polyethylene fibre plastics
- ☐ 06.11.500 Polyethylene-aluminium fillers
- ☐ 06.11.600 Polyethylene spraying plastics

### 06.12.000 One and two-part fillers

- ☐ 06.12.100 NC combination fillers
- ☐ 06.12.200 Wet-in-wet fillers
- ☐ 06.12.300 Reaction fillers
- ☐ 06.12.400 Epoxy priming fillers
- ☐ 06.12.500 Thick layer fillers
- ☐ 06.12.600 Polyurethane fillers (PU)
- ☐ 06.12.700 Transparent fillers

### 06.13.000 Top coats

- ☐ 06.13.100 Acrylic car paints
- ☐ 06.13.200 Metallic base coats (conventional)
- ☐ 06.13.300 Metallic base coats (aqueous)
- ☐ 06.13.400 Special effect paints
- ☐ 06.13.500 Structural paint coatings
- ☐ 06.13.600 Compact paints

### 06.14.000 Additives

- ☐ 06.14.100 Hardeners
- ☐ 06.14.200 Acrylic gloss additives
- ☐ 06.14.300 Acrylic converters
- ☐ 06.14.400 Activators
- ☐ 06.14.500 Additives for metallic base coats
- ☐ 06.14.600 Antisilicone additives
- ☐ 06.14.700 Matting agents
- ☐ 06.14.800 Flow control agents
- ☐ 06.14.900 Non-stop sealers

### 06.15.000 Thinners

- ☐ 06.16.000 Stone shield
- ☐ 06.16.100 Underbody protection
- ☐ 06.16.200 Cavity sealing

- ☐ 06.17.000 Paint removers
- ☐ 06.17.100 Strippers
- ☐ 06.17.200 Paint strippers

- ☐ 06.18.000 Paint care products
- ☐ 06.18.100 Polishes
- ☐ 06.18.200 Grinding pastes
- ☐ 06.18.300 Preservatives

#### **Thermal-insulating composite systems, seals, wall and floor coverings, wall papers, redevelopment and repair**

##### **07. Concrete repair**

- ☐ 07.10.000 Concrete protection
- ☐ 07.11.000 Concrete repair systems
- ☐ 07.12.000 Filling cracks in concrete
- ☐ 07.13.000 Tools and equipment for repairing concrete
- ☐ 07.14.000 Test and measurement equipment for repairing concrete
- ☐ 07.15.000 Renovating concrete

##### **08. Thermal-insulating composite systems**

- ☐ 08.10.000 Thermal-insulating composite systems
- ☐ 08.11.000 Additional materials for thermal-insulating composite systems
- ☐ 08.12.000 Tools and equipment for thermal-insulating composite systems
- ☐ 08.13.000 Sealants
- ☐ 08.14.000 Insulating materials
- ☐ 08.15.000 Facade construction materials

##### **09. Joint seals**

- ☐ 09.10.000 Joint fillers
- ☐ 09.11.000 Joint filling tapes
- ☐ 09.12.000 Foam sealant tapes
- ☐ 09.13.000 Sealing profile systems
- ☐ 09.14.000 Additives for joint sealing
- ☐ 09.15.000 Airtight construction work
- ☐ 09.16.000 Profiles, plaster lathing, fabrics
- ☐ 09.17.000 Protective materials
- ☐ 09.18.000 Dry-lining accessories

##### **10. Ceiling, wall and floor coverings and laying and coating systems**

- ☐ 10.10.000 Ceiling panels
- ☐ 10.11.000 Wall coverings in sheets
- ☐ 10.12.000 Wall panels, tiles
- ☐ 10.13.000 Floor coverings in panels and sheets
- ☐ 10.14.000 Carpets in panels and sheets
- ☐ 10.15.000 Floorboard levelling fillers
- ☐ 10.16.000 Floorboard coating systems
- ☐ 10.17.000 Carpet underlays
- ☐ 10.18.000 Insulating coverings
- ☐ 10.19.000 Solar protection foils
- ☐ 10.20.000 Liquid, dry and cement screeds
- ☐ 10.21.000 Lime, cement, ready-mix and renovation plasters
- ☐ 10.22.000 Gypsum plasters and plasterboards
- ☐ 10.23.000 Coving and decorating elements
- ☐ 10.24.000 Plaster profiles
- ☐ 10.25.000 Foundations and reinforcements for plasters
- ☐ 10.26.000 Fire protection constructions
- ☐ 10.26.100 Wall and ceiling structures

- ☐ 10.26.200 Dry lining, dry-lining systems
- ☐ 10.27.000 Strapping and mounting technology for ceilings and walls
- ☐ 10.28.000 Ceiling systems of plaster, mineral wool, metal and wood materials
- ☐ 10.29.000 Dry-lining systems for floors, walls, ceilings and facades
- ☐ 10.30.000 Sound insulating materials
- ☐ 10.31.000 Thermal-insulating systems and heat-insulating plasters
- ☐ 10.32.000 Calcium sulphate screeds
- ☐ 10.33.000 Fast screeds
- ☐ 10.34.000 Joint profiles for moving joints
- ☐ 10.35.000 Profiles for stair edges and tile coverings, balcony and terrace systems
- ☐ 10.36.000 Reinforcements from grid mats or fibres
- ☐ 10.37.000 Surface drainage from sheets or panels
- ☐ 10.38.000 Edge insulating strips
- ☐ 10.39.000 Decoupling sheets and plates
- ☐ 10.40.000 Building boards
- ☐ 10.41.000 Composite elements from polystyrene with mortar coating and fabric reinforcement
- ☐ 10.42.000 Footfall sound insulation
- ☐ 10.43.000 Mounting technology
- ☐ 10.44.000 Floors
- ☐ 10.44.100 Industrial flooring
- ☐ 10.44.200 Parquet
- ☐ 10.44.300 Laminate
- ☐ 10.45.000 Fire protection
- ☐ 10.46.000 Ceilings
- ☐ 10.47.000 Facade construction materials
- ☐ 10.48.000 Plaster and lime building materials
- ☐ 10.49.000 Cellar renovation, wall damp-proofing, footings
- ☐ 10.50.000 Natural stone, metal coverings, window sills
- ☐ 10.51.000 Plasters and plaster systems
- ☐ 10.52.000 Sound insulation, interior acoustics
- ☐ 10.53.000 Stucco, Acoustic plasters, acoustic coverings
- ☐ 10.54.000 Elastic surface coverings
- ☐ 10.55.000 Cork coverings

##### **11. Tile and panel-laying systems**

- ☐ 11.10.000 Composite seals from sheets, foils or liquid thin-bed mortar systems, cement, reaction resins, emulsions
- ☐ 11.11.000 Bond coats
- ☐ 11.12.000 Levelling fillers and fillers
- ☐ 11.13.000 Primers
- ☐ 11.14.000 Joint mortar, cement, reaction resins, emulsions
- ☐ 11.15.000 Adhesives
- ☐ 11.16.000 Impregnation, care and sealing materials, cleaning systems
- ☐ 11.17.000 Tiles and natural stones

##### **12. Tiles and panels**

- ☐ 12.10.000 Ceramic tiles and panels
- ☐ 12.11.000 Mosaics
- ☐ 12.12.000 Natural shaped stone
- ☐ 12.13.000 Glass tiles
- ☐ 12.14.000 Artificial stone
- ☐ 12.15.000 Bordures / listelli
- ☐ 12.16.000 Glass bricks
- ☐ 12.17.000 Clinker
- ☐ 12.18.000 Skirting boards

##### **13. Preservation of historic buildings and monuments**

- ☐ 13.10.000 Restoration supplies
- ☐ 13.11.000 Pigments
- ☐ 13.12.000 Historical construction materials
- ☐ 13.13.000 Materials to replace stone
- ☐ 13.13.100 Stucco
- ☐ 13.14.000 Doors





**14. Illumination, controlled ventilation and extraction, building technology, surface heating systems, electric heating mats**

- ☐ 14.10.000 Wall heating systems
- ☐ 14.11.000 Ventilation systems

**15. Ecological construction materials**

- ☐ 15.10.000 Insulating materials
- ☐ 15.11.000 Clay materials
- ☐ 15.12.000 Wood products
- ☐ 15.13.000 Recycling materials
- ☐ 15.14.000 Tile materials
- ☐ 15.15.000 Floor coverings
- ☐ 15.16.000 Plaster mortars

**16. Wall coverings, wallpapers, special wallpapers, stretch fabrics and decorations**

- ☐ 16.10.000 Wallpapers (wet and dry finishable)
- ☐ 16.11.000 Woodchip and embossed wallpapers, unprinted
- ☐ 16.12.000 Special wallpapers
- ☐ 16.13.000 Plastic-coated carriers
- ☐ 16.14.000 Materials for wallpaper underlay
- ☐ 16.15.000 Underpapers with smoothing effect
- ☐ 16.16.000 Insulating foils
- ☐ 16.17.000 Stretch fabrics
- ☐ 16.18.000 Heat insulating materials (internal)
- ☐ 16.19.000 Wall fillers
- ☐ 16.20.000 Surface techniques

**Tools, spraying systems and equipment, adhesive and auxiliary materials**

**17. Adhesives**

- ☐ 17.10.000 Wallpaper pastes
- ☐ 17.11.000 Special pastes
- ☐ 17.12.000 Adhesives for ceiling and wall coverings
- ☐ 17.13.000 Adhesives for floor coverings
- ☐ 17.14.000 Adhesives for ceramic tiles
- ☐ 17.15.000 Adhesives for flocking

**18. Auxiliary materials**

- ☐ 18.10.000 Strippers and stripping materials
- ☐ 18.11.000 Fluates
- ☐ 18.12.000 Blocking materials
- ☐ 18.13.000 Degreasing agents
- ☐ 18.14.000 Phosphatizing materials
- ☐ 18.15.000 Solvents, thinners and cleaning agents
- ☐ 18.16.000 Wood protection materials
- ☐ 18.17.000 Impregnating materials
- ☐ 18.18.000 Water-repellent materials (hydrophobic agents)
- ☐ 18.19.000 Fillers
- ☐ 18.20.000 Insulating materials
- ☐ 18.21.000 Corner protection rails
- ☐ 18.22.000 Reinforcing materials and fabrics
- ☐ 18.23.000 Brush cleaners
- ☐ 18.24.000 Wallpaper releasers
- ☐ 18.25.000 Insulating materials (vapour barriers)
- ☐ 18.26.000 foils, papers, protective foils, protective sheets, protective grids
- ☐ 18.27.000 Masking tapes
- ☐ 18.28.000 Marking tapes
- ☐ 18.29.000 Abrasive papers and materials
- ☐ 18.30.000 Polishing materials

**19. Paint spraying equipment and systems**

- ☐ 19.10.000 Low-pressure spraying equipment
- ☐ 19.11.000 High-pressure spraying equipment
- ☐ 19.12.000 Airless spraying equipment
- ☐ 19.13.000 Hot-spraying equipment
- ☐ 19.14.000 Electrostatic spraying equipment
- ☐ 19.15.000 Spraying guns
- ☐ 19.16.000 Accessories for spray equipment / guns
- ☐ 19.17.000 Compressors
- ☐ 19.18.000 Spraying and drying systems
- ☐ 19.19.000 Spraying cabins, combination cabins, drying cabins
- ☐ 19.20.000 Small painting systems
- ☐ 19.21.000 Dip painting systems
- ☐ 19.22.000 Powder coatings
- ☐ 19.23.000 Flocking
- ☐ 19.24.000 Paint mist extraction systems, spray booths, spraying walls
- ☐ 19.25.000 Multi-component spray equipment

**20. Tools, equipment and machines**

- ☐ 20.10.000 Paintbrushes and brushes
- ☐ 20.11.000 Paint rollers
- ☐ 20.12.000 Painting tools
- ☐ 20.13.000 Wallpapering tools and tables
- ☐ 20.14.000 Devices for rolling up broad wallpaper with counter and cutting device
- ☐ 20.15.000 Floor tiling tools
- ☐ 20.16.000 Tools and equipment for cutting insulating boards and reinforcing fabrics
- ☐ 20.17.000 Tools for painting vehicles
- ☐ 20.18.000 Gilding tools
- ☐ 20.19.000 Grinding and polishing machines
- ☐ 20.20.000 Jet blowers
- ☐ 20.21.000 Stirring apparatus and pumps (solvent pumps)
- ☐ 20.22.000 Flood systems
- ☐ 20.23.000 Immersion systems
- ☐ 20.24.000 Tools for laying tiles
- ☐ 20.25.000 Equipment for gluing wallpaper
- ☐ 20.26.000 Flame cleaning devices
- ☐ 20.27.000 Steam and hot water devices
- ☐ 20.28.000 Cement spraying devices
- ☐ 20.29.000 Spray pump equipment
- ☐ 20.30.000 Tools for gluing wall tiles
- ☐ 20.31.000 Electrostatic flocking devices
- ☐ 20.32.000 Testing and measuring equipment for coatings and bases
- ☐ 20.33.000 Paint mixing equipment
- ☐ 20.34.000 Cutting equipment
- ☐ 20.35.000 Tools for surface design
- ☐ 20.36.000 High-pressure cleaning equipment
- ☐ 20.37.000 Equipment for building sites
- ☐ 20.38.000 Home / office containers
- ☐ 20.39.000 Toilets
- ☐ 20.40.000 Shower cabins
- ☐ 20.41.000 Recreation rooms
- ☐ 20.42.000 Tools for surface finishing
- ☐ 20.43.000 Chisel hammers
- ☐ 20.44.000 Needle guns
- ☐ 20.45.000 Air conditioning systems
- ☐ 20.46.000 Air humidifiers and dehumidifiers
- ☐ 20.47.000 Heating units
- ☐ 20.48.000 Compressed air tools
- ☐ 20.49.000 Filter materials
- ☐ 20.50.000 devices, carpet cleaning devices, vacuum cleaners
- ☐ 20.51.000 Corrosion protection / cleaning / processing
- ☐ 20.52.000 Machines and equipment for dry lining and assembly
- ☐ 20.53.000 Processing machines for plasters and flooring, conveying equipment
- ☐ 20.54.000 Tile-cutting and polishing tools
- ☐ 20.55.000 Screed pumps
- ☐ 20.56.000 Measuring instruments



- ☐ 20.57.000 Sand-blasting and mortar machines
- ☐ 20.58.000 Waste water disposal and treatment
- ☐ 20.59.000 Industrial vacuum cleaners
- ☐ 20.60.000 Sawing, milling etc.
- ☐ 20.61.000 Slab-cutters
- ☐ 20.62.000 Tools

## Ladders and scaffolding, occupational safety

### 21. Ladders and scaffolding

- ☐ 21.10.000 Ladders
- ☐ 21.11.000 Trestles and horses
- ☐ 21.12.000 Erecting decks
- ☐ 21.13.000 Elevating erecting decks, sky lifts
- ☐ 21.14.000 Scaffolding
- ☐ 21.15.000 Construction site logistics, vehicles
- ☐ 21.16.000 Scaffolding and ladders

### 22. Devices and equipment for environmental protection and workshops

- ☐ 22.10.000 Waste-water collection systems
- ☐ 22.11.000 Waste-water processing
- ☐ 22.12.000 Waste-air purification plants
- ☐ 22.13.000 Disposal of varnish and paint residues, waste, residual materials
- ☐ 22.14.000 Collection containers
- ☐ 22.15.000 Collection and disposal containers
- ☐ 22.16.000 Catchment basins
- ☐ 22.17.000 Recycling systems for solvents

### 23. Occupational safety

- ☐ 23.10.000 Safety clothing, protective wear
- ☐ 23.11.000 Breathing masks
- ☐ 23.12.000 Skin and personal protective equipment
- ☐ 23.13.000 Information, warning and prohibitive signs
- ☐ 23.14.000 Protective clothing, occupational safety

## Lettering, gilding, IT, trade media, miscellaneous

### 24. Lettering / signage, screen printing, gilding

- ☐ 24.10.000 Finished letters
- ☐ 24.11.000 Stamp sets
- ☐ 24.12.000 Self-adhesive letters
- ☐ 24.13.000 Cutting foils, adhesive tapes
- ☐ 24.14.000 Screen printing equipment

- ☐ 24.15.000 Screen printing systems
- ☐ 24.16.000 Light and phototypesetting equipment
- ☐ 24.17.000 Screen printing inks
- ☐ 24.18.000 Glass paints
- ☐ 24.19.000 Gold leaf, silver leaf, metal leaf
- ☐ 24.20.000 Bronze paints, bronzes, mixtion

### 25. Information technology

- ☐ 25.10.000 Hardware
- ☐ 25.11.000 Software
- ☐ 25.12.000 Consulting
- ☐ 25.13.000 Computers for colour design
- ☐ 25.14.000 Software for colour design
- ☐ 25.15.000 Bathroom planning software
- ☐ 25.16.000 Building site computers
- ☐ 25.17.000 IT, office organisation, communication

### 26. Miscellaneous and trade media

- ☐ 26.10.000 Artists' paints, all types of painting and drawing utensils
- ☐ 26.11.000 Technical books
- ☐ 26.12.000 Trade publications
- ☐ 26.13.000 Colour swatches
- ☐ 26.14.000 Work clothing
- ☐ 26.15.000 Office organisation, office furnishing
- ☐ 26.16.000 Trim foils, self-adhesive foils
- ☐ 26.17.000 Carpet trim and rods
- ☐ 26.18.000 Decorative strips, ornamental profiles, decorative rosettes, ornaments and similar products
- ☐ 26.19.000 Door frame seals, all types of skirting boards, panels and sawn timber
- ☐ 26.20.000 Advertising and sales stands
- ☐ 26.21.000 Fittings for specialist paint shops
- ☐ 26.22.000 Workshop fittings
- ☐ 26.23.000 Store fittings
- ☐ 26.24.000 Services
- ☐ 26.25.000 Presentation systems for wall and floor coverings
- ☐ 26.26.000 Barrier-free construction
- ☐ 26.27.000 Entrance areas, staircases
- ☐ 26.28.000 Financing
- ☐ 26.29.000 Franchise systems
- ☐ 26.30.000 First-hand planning
- ☐ 26.31.000 Publishers, associations, institutions
- ☐ 26.32.000 Further training
- ☐ 26.33.000 Edit formats, accessories, auxiliary materials
- ☐ 26.34.000 Cleaning and maintenance products for elastic, textile, laminate, parquet, cork coverings
- ☐ 26.35.000 Graffiti removal and protection



Please note that this information is not published automatically in the official media. You will be contacted in due time by our service provider for information to be listed in the official media.



The product range is an integral part of the application form.  
Please return the product range form to us together with the application form.

Place/date

Company stamp/legally binding signature

# ALL-INCLUSIVE STAND

The simplest way of ensuring successful participation.



**FARBE, AUSBAU  
& FASSADE**

20. – 23. March 2019  
Cologne Exhibition Center

1

## **Superior, affordable and with a personal note – "all-inclusive": Stand area, stand construction and fitting.**

We are pleased to offer you the possibility of renting a full-service stand. You only need to place the articles you are exhibiting to complete your event set-up. You do not have to organise anything else – apart from your contacts. We will take care of all the rest.

**It could not be any easier for you.**

The all-inclusive stand includes the following:

- Stand area and stand construction
- Daily cleaning and waste collection
- Free exhibitor passes (a minimum of 3) depending on stand size (see Terms of Participation, section 8)
- Promotional package will be sent to you automatically (self-adhesive stickers, DIN A1 posters, visitor leaflets)
- Press info tray in the Press Centre during the trade fair

2

## **All-inclusive stand:**

Row stand (1 side open)	€ 256.00 /m²*
Corner stand (2 sides open)	€ 267.00 /m²*

\* Net price excluding AUMA levy, excluding statutory VAT, excluding media allowance, excluding MyBusiness premium allowance, including stand area and stand construction.

**Power:** 3 kW mains connection (incl. consumption), 1 AC power socket, 1 earthing connection for stand

**Lettering:** Panel 200 x 50 cm, white, 15 characters included,  
optional at extra cost: logo on coloured walls

**Miscellaneous:** Construction and completion by agreed date, preliminary cleaning before start of event, dismantling after the event.

## **System stand OCTANORM**

- Rep carpet light grey/ anthracite grey/ blue/ red/ green including fitting, disposal and covering during set-up
- Walls white, height 250/350 cm, side panels can be selected from an additional 5 colours (in consultation with the stand builder)
- 1 table, 70 x 70 cm, 4 chairs
- 1 info counter, open, white
- 1 bar stool
- 1 cabinet, lockable (1 m²), with coat rack and waste-paper basket
- Lighting, 1 spot per 3 m², approx. 100 W
- Individual on-site support from the stand builder

## **Optional:**

Digital printing on side panels at extra cost.

The stand will be adapted to the allotted size and shape, and you will receive a plan for fine tuning together with an order form for additional fittings.

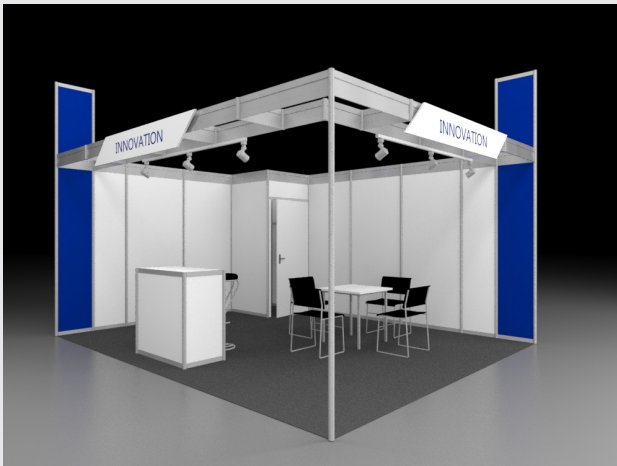

Example: Corner stand 5 x 4 m (20 m²)

## **All-inclusive stand concept:**

GHM will commission MEPLAN GmbH, Olof-Palme-Strasse 1, 81829 Munich, Tel: +49 89 949 283 81, Fax: +49 89 949 249 89 to perform the work for the stand construction and technical services listed in the all-inclusive offer on your behalf. When the stand offer is booked, arrangements will be made with MEPLAN GmbH direct. Additional services and special requests not covered by the scope of the all-inclusive stand offer must be arranged with MEPLAN GmbH direct, who will also invoice customers direct.

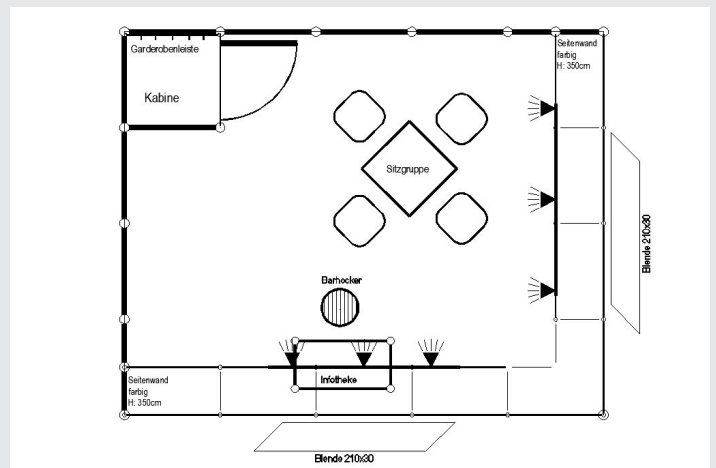

Stand layout (Example)



# Terms of Participation

Last updated: Mai 2017

## 1. General information about the event

Event:	FARBE, AUSBAU & FASSADE 2019
Venue:	Cologne Exhibition Center
Event duration:	Wednesday – Saturday, 20 – 23 March 2019
Opening times:	9:00 a.m. – 6:00 p.m. Wednesday – Friday 9:00 a.m. – 4:00 p.m. Saturday
Set-up times:	Start: Thursday, 14 March 2019 till Monday 18 March 2019, 7:00 a.m. – 10:00 p.m. Tuesday 19 March 2019, 7:00 a.m. – 6:00 p.m. End: Tuesday 19 March 2019, 7:00 a.m. – 6:00 p.m.
Latest permissible set-up date:	Tuesday 19 March 2019, 12:00 noon
Dismantling:	Start: Saturday 23 March 2019, from approx. 5:00 p.m. till End: Tuesday 26 March 2019, midnight

The setting up and dismantling times must be strictly adhered to.

Information on setting up and dismantling will be made available in good time.

Setting up a stand on Tuesday 12 March 2019 and Wednesday 13 March 2019 will incur a charge and must be arranged with GHM in advance. GHM reserves the right to issue passes for setting up and dismantling.

## 2. Registration and conclusion of contract

The application form must be completed in full and duly signed and stamped before being sent to GHM in order for registration to be effective. Registrations from within the EU must bear the appropriate VAT registration number. The submission of the application form is legally binding for the exhibitor. Any amendments, additions and deletions made to the application form or to the Terms of Participation will have no effect. A contract will be established on acceptance by GHM.

GHM will generally confirm receipt of the registration; this does not constitute acceptance of the registration. GHM will submit an offer of location to the exhibitor following an examination period that may last several months. If the exhibitor does not decline the offer of location within an appropriate period named therein, GHM will then send the exhibitor notification of acceptance with the offer of location. This results in the contract coming into existence.

The technical guidelines, the venue's house rules and future circulars in digital or printed form are an integral component of the Terms of Participation. These are subject to subsequent changes, which are then binding for the event.

GHM reserves the right to make changes or amendments that relate to technical arrangements and safety.

## 3. Acceptance

Unless the exhibitor, as an exception, has a legal entitlement to acceptance to participate, GHM reserves the right to deny acceptance as it deems fit. The exhibitor must in all cases supply details of its product range and must provide an assurance that the products exhibited correspond to its product range in order for the application to be approved. A further requirement is that the exhibitor is the manufacturer of the products. Other forms of sales channel may only be permitted if they have been authorised by the manufacturer of the products that are being exhibited. This is intended to ensure an equilibrium and diversity of the products on offer. Any exhibition products breaching the provisions of industrial property law in Germany (illegal copies) are prohibited. GHM may revoke acceptance if it was granted as a result of incorrect information or if the prerequisites for acceptance have become void.

GHM is entitled to withdraw from the contract if good cause exists. Good cause exists in particular when an application for insolvency proceedings to be initiated is filed, when such an application is rejected due to insufficient assets or when insolvency proceedings are actually opened. GHM must be notified of this immediately.

GHM is entitled to make acceptance dependent on the timely payment of a registration deposit.

The exhibitor may not sub-let or cede any stand registered in its name.

## 4. Stand position and occupation, technical services

The position of the stand will be decided exclusively by GHM. In the interests of the trade fair, GHM is entitled to assign a different position or different size of stand to that listed in the allocation or acceptance and also to reposition or close entrances and exits to the fair site or to the halls or to make structural changes. The exhibitor herewith waives any claims to compensation that may arise or have arisen from the changes described above. However, any rent already paid must be reimbursed to the exhibitor on a pro rata basis. Any projecting elements, columns or joists are considered to be part of the area assigned.

The exhibitor is obliged to occupy the stand and to exhibit the registered products without restriction; other products may not be exhibited. The exhibitor guarantees that it has unrestricted power of disposal over the registered exhibition products and that they are new articles. Used articles are not permitted.

The exhibitor must order all technical services (e.g. water, electricity) from the operator of the venue with whom the exhibitor will conclude a separate contract.

Exhibitors will be charged a proportional flat-rate energy fee per square metre of occupied stand area, including any accessible upper floor, for electricity/water, compressed air etc.

## 5. Terms of payment and due dates

The invoice for participation will be issued to the exhibitor when acceptance is given. The invoice will cover the aforementioned participation fee including the rent for the stand space, the basic number of exhibitor passes, advice and service from GHM, visitor promotion as well as press and public relations work for the event. **The invoice for participation fee is payable by 31 October 2018 at the latest.** Should the invoice be issued after 31 October 2018, it will be payable within 14 days of the date on invoice, or if the period up to the commencement of the event is shorter, by the first day of setting up at the latest. If payment is not made in time, GHM will be entitled to withdraw from the contract immediately and to claim compensation, which will be determined by the applicable provisions of section 13 Cancellation and space reduction.

GHM will issue an invoice to the exhibitor after the event containing a final calculation of charges for the services provided by GHM so far not billed. This invoice is payable within 14 days of the date of the invoice. In the event of a delay in payment interest on arrears will be charged in the legally specified amount.

Any fees, bank charges, taxes or levies, in particular VAT, must be paid by the exhibitor. Any amounts retained or deducted by third parties such as taxes and charges withheld at the exhibitor's place of origin will have no effect for GHM. All payments must be made in EUROS. Any complaints regarding invoices must be made within eight days of receipt of the invoice. Complaints at a later date cannot be considered.

## 6. Offset exclusion

The exhibitor is not entitled to offset claims for payment by GHM with counterclaims unless the counterclaims have been legally established or recognised by GHM.

## 7. Beneficiary, re-issuing of invoices

The following applies to exhibitors with their registered office in the European Union (excluding Germany): the exhibitor confirms as beneficiary of the services that all services rendered by GHM as service provider will be used for its own business and not for any third-party commercial or private purposes. This declaration will remain valid until revoked in writing. In the event that the exhibitor does not use the service for its own business purposes, GHM will not be liable for any damage or loss that may arise as a result, in particular for any VAT subsequently charged. The exhibitor must communicate its VAT registration number to GHM as confirmation and proof of its business use. Should the exhibitor fail to communicate its VAT registration number, GHM will assume that the service is assessable and liable for tax in Germany and will invoice VAT accordingly. The same applies to a VAT registration number for which the Federal Central Tax Office does not issue a notification of confirmation as well as in the event of the VAT registration number being declared invalid.

For VAT-related reasons GHM is unable to issue or re-issue invoices for services that GHM has rendered, or will render, to the exhibitor as contracting partner to a different invoice than the exhibitor. Should the exhibitor request a change to an invoice that has already been issued, e.g. in the event of a change to the company name, to the company's legal form or to its address, the exhibitor will have to pay an amount of € 50 plus VAT. This fee will not be payable in the event of GHM being responsible for incorrect details.

## 8. Exhibitor passes

Every exhibitor will receive free exhibitor passes for itself and its staff in accordance with the stand size; the passes will be valid for the duration of the event. For a stand size of

up to 20 m <sup>2</sup>	3 exhibitor passes
up to 100 m <sup>2</sup>	1 additional exhibitor pass for each additional area of 10 m <sup>2</sup> or part thereof
over 100 m <sup>2</sup>	1 additional exhibitor pass for each additional area of 20 m <sup>2</sup> or part thereof

Any further exhibitor passes will be charged for.

Exhibitor passes will be available after settlement of the invoice for participation. Their use is reserved solely for stand staff; it is forbidden to pass them on to third parties or to sell them. They will be blocked in the event of abuse.

## 9. Co-exhibitor/additional company represented

A co-exhibitor/additional company represented is any other business represented at the stand, regardless of whether with its own staff or merely with their own exhibition products or services. This includes affiliate companies, subsidiaries, sales branches or agencies.

The stand area is allocated as a single unit and to one exhibitor only (contracting partner). Co-exhibitors must be registered by the exhibitor (contracting partner) using a separate application form.

The acceptance of the co-exhibitor/additional company represented does not result in an additional contract between it and GHM. Instead, it is the exhibitor's responsibility to



ensure that its co-exhibitors/additional companies represented observe the provisions of the contract and the guidelines. The exhibitor bears the same liability for faults of its co-exhibitors/additional companies represented as it does for its own faults.

Acceptance of co-exhibitors/additional companies represented is subject to payment. The exhibitor must make such payment; it can be invoiced subsequently by GHM. The exhibitor will also be liable towards GHM for any services provided by GHM to co-exhibitors/additional companies represented. Should GHM invoice services directly to co-exhibitors/additional companies represented, this will not diminish the exhibitor's joint liability.

#### **10. Stand design**

Stand areas do not include stand construction or technical services. The exhibitor is responsible for the design and construction of the stand and any required compliance with legal provisions, the technical guidelines, circulars and terms of participation that may result therefrom. The exact details of the technical guidelines can be found on the website. An excerpt is included in the Terms of Participation in the appendix „Important notes“.

#### **11. General information about operating a stand**

During official event opening hours, the stand must always be manned by competent members of staff, must be properly equipped and made accessible to visitors. A premature abandonment of the fair stand constitutes a serious breach of these Terms of Participation which will entitle GHM to refuse to accept the exhibitor for future events organised by GHM.

Exhibition materials that, owing to their appearance, smell, noise, vibrations or similar properties, pose a significant risk or disturbance for other exhibitors, visitors or exhibition products of other exhibitors must be removed immediately at GHM's request. This obligation on the part of the exhibitor also exists even when it indicated such properties in the application form and were previously accepted by GHM.

#### **12. Special events**

Any event held by the exhibitor on its stand going beyond a usual company presentation or demonstration requires the prior written consent of GHM. GHM is however entitled to place restrictions on or completely prohibit previously approved events if they threaten to disrupt the orderly operation of the fair or of other exhibitors. Audio and audio-visual presentations as well as any other sources of noise are only permitted at the stand provided that they comply with the German Ordinance on Occupational Safety concerning Noise and Vibration Protection in accordance with DIN 15905 Part 5 when measured at the stand boundary. If noise levels exceed this, GHM is entitled to intervene and, where necessary, close the stand in line with section 15 Revocation of allocation, stand closure. The individual company/exhibitor is responsible for submitting the relevant applications to GEMA and other copyright associations. It is agreed by both sides that the general purpose of the fair and the general interest of the exhibitors is to maximise the flow of customers (= visitors). The exhibitor accordingly agrees not to attract visitors to other locations away from the trade fair site during official opening hours. In the event of any infringement of this provision, GHM is entitled to close the stand in line with section 15 Revocation of allocation, stand closure.

#### **13. Cancellation and space reduction**

Should the exhibitor cancel its allocation in part or full or reduce the allocated space, GHM will strive to rent the area out to another exhibitor. There is, however, no obligation for GHM to do this. Furthermore, cancellation will not affect the exhibitor's payment obligations in accordance with the invoice for participation for the original acceptance.

Should GHM succeed in renting the area out to another exhibitor in part or in full, the amount recovered for the floor space rented out to another exhibitor will be reimbursed to the exhibitor. If another exhibitor already registered relocates its stand to the vacated space, it will only be deemed as letting to a third exhibitor if and to the extent that a higher rent can be generated from this vacated stand and/or the space vacated by the other exhibitor can be rented out to another exhibitor.

In addition, if the cancelled floor space can be rented out to a third party in part or in full the exhibitor will still be liable to GHM for payment off a fixed sum as compensation for the costs incurred by the additional activity. From the date of acceptance, this will amount to 25 % of the total agreed participation fee, however at least € 1.000 plus VAT and must be offset against any reimbursement that might be paid. The entire co-exhibitor fee is payable on cancellation by a co-exhibitor/additional company represented.

Any additional services ordered must be cancelled with the respective contracting partner and are subject to the relevant contractual terms and conditions.

#### **14. Official media (catalogue, Internet, mobile)**

GHM will publish official exhibitor media. GHM reserves the right to choose the appropriate medium (online/print). GHM will appoint a service provider (hereinafter: provider) to prepare the official media (exhibitor directory).

GHM's provider is  
Company: j.l.medien e.K.  
Street: Inselkammerstr. 5  
Postcode/town: 82008 Unterhaching, Germany

Where GHM invoices a media allowance together with the services it renders, the allowance includes the following services:

- Full entry in the directory of exhibitors (name, address, telephone, fax, internet address, e-mail address, hall/stand)
- Product names (indication of product offering)
- Indication of brand names in brand directory

The provider will contact the exhibitor in order to discuss the details of the content of the entry covered by the media allowance. GHM's provider will also provide the exhibitor with information on additional design options and, where applicable, will conclude a direct agreement based on the provider's relevant terms and conditions.

The details supplied to GHM on the registration form are not considered to be the specifications for the entry. In the case of exhibitors who fail to submit their order in good time, GHM will be entitled to arrange for an entry in the official medium based on the registration documents supplied without any liability for their accuracy. It will no longer be possible to include an entry in the print medium if registration is received after the print medium goes to press. This will not result in an entitlement to a reduction in the media allowance or to compensation. Payments already made will not be reimbursed.

Any claims on the part of GHM against the provider with regard to defects in the publication of the exhibitor's entry in the official medium are herewith assigned to the exhibitor. In return, the exhibitor waives any entitlement to assert such claims against GHM.

#### **15. Revoking allocation, stand closure**

GHM is entitled to revoke any stand allocation already made (allocation, acceptance of offer) or to close the exhibitor's stand if:

1. the exhibitor still has outstanding debts from previous trade fairs or
2. the exhibition products do not correspond to the subject of the trade fair, or
3. the selling regulations specified in section 17, Sales arrangements, are not observed, or
4. promotional material is distributed in violation of the provisions in section 18, Ban on the distribution of promotional material, or
5. the provisions regarding special events specified in section 12 are not observed or
6. the exhibitor is otherwise in significant breach of its contractual obligations, in particular the obligations contained in the Terms of Participation, house rules and user regulations and the technical guidelines. The exhibitor will be liable to GHM for all damage or loss incurred in the above cases.

GHM must only provide the exhibitor with prior warning in cases where this is deemed necessary with regard to the severity of the breach and the duration and purpose of the trade fair. GHM is also entitled to issue a temporary or permanent ban on participation in future trade fairs. Compensation claims or any other claims on the part of the exhibitor are excluded. Any claims on the part of GHM are subject to the provisions specified in section 13, Cancellation and space reduction.

#### **16. Occupation of stand, end of trade fair**

The exhibitor only has a claim to the allocated stand space after full settlement of the invoice for participation has been made or proof of this has been presented. Stand set up must commence by midday at the latest on the day preceding the opening of the fair. If the rented space is not occupied by this time, or if no notification has been given, GHM reserves the right to dispose of the space in another manner from this time onward without having to give notice thereof. Claims on the part of GHM will be determined in accordance with section 13, Cancellation and space reduction.

Set up work must be terminated by 6 p.m. on the final day reserved for setting up. If the setting up period is exceeded, GHM is entitled to have the stand superstructures removed and stored at the exhibitor's cost and risk. The original condition must be restored after dismantling. The exhibitor must compensate GHM for any damage caused by improper handling.

The stand must be duly occupied until the official end of the trade fair. A penalty of € 2,000.00 will be due on breach of this provision.

#### **17. Sales arrangements**

The direct sale and/or supply of any type of goods, including samples, is prohibited at trade fairs (with the exception of trade-related media).

#### **18. Ban on the distribution of promotional material**

Exhibitors may neither affix nor distribute promotional materials such as company signs, brochures or posters outside of their allocated stand space without the written consent of GHM. A penalty of € 2,000.00 will be due on each breach of this provision. Moreover, the stand may be closed in accordance with section 15 Revoking allocation, stand closure.

#### **19. Cleaning**

The exhibitor is obliged to clean its stand on a daily basis. If the stand is not cleaned by the exhibitor's own staff, only cleaning service providers approved by GHM may be contracted. Any waste generated by the exhibitor will be disposed of at the exhibitor's expense. The exhibitor must arrange and supervise the disposal of waste. GHM is only responsible for cleaning the venue site and the hallways.

#### **20. Smoking**

Smoking is forbidden in enclosed spaces over the entire Exhibition Centre.





### 21. Films/photography

The exhibitor is only permitted to make video and audio recordings during opening times inside its own stand. The exhibitor must request permission from GHM for any filming/photography activity beyond this.

GHM may make video and audio recordings throughout the trade fair venue and use these for its own or general publication purposes. Where necessary for this purpose, the exhibitor will grant GHM permission to avail itself of all intellectual or other property rights which it possesses in its own right or which it has otherwise been granted and assures GHM that it is entitled to grant such permission. Where required, the exhibitor will grant such permission in good time and at its own cost or inform GHM that it is not able to grant such permission. The exhibitor will release GHM from all liability for third-party and compensation claims in this regard.

### 22. Security

GHM is responsible for overall security in the exhibition halls and at the entrances to the trade fair. Each exhibitor must take care of security for its own stand and for its exhibition products. Appropriate security guards can only be arranged with a GHM-approved security company; the costs for the service must be paid to the company directly.

### 23. Right of lien

On acceptance of the exhibitor's registration GHM will have a right of lien over all objects in the fair stand in order to secure its claims against the exhibitor.

### 24. Liability and insurance

GHM is obliged to enable the exhibitor to occupy and use its stand in accordance with the terms and conditions of this contract. GHM must maintain the halls and the access ways in a usable condition and clean them. Section 19, Cleaning, remains unaffected.

GHM is only liable towards exhibitors for damage due to a wilful or grossly negligent breach of contract by GHM or to a wilful or grossly negligent breach of obligation on the part of a legal representative or agent of GHM. In the event of slight negligence GHM will only be liable for a breach of fundamental contractual obligations, i.e. a breach of those obligations that the exhibitor can rely on to be complied with. Any claims relating to culpable injury to life, body or health remain unaffected.

The aforementioned limitations of liability apply for exhibitors who are businesspersons with the provision that liability will in no way be accepted for damage or loss to goods used by exhibitors or to the stand fixtures and fittings. It is immaterial whether the damage or loss occurs prior to, during or after the event. The same applies to the vehicles parked on the trade fair site by exhibitors, their employees or agents. Liability is also excluded for indirect damage and resulting loss of profit.

Exhibitors themselves are liable for any damage or loss that may be culpably caused by themselves, their employees, their agents or their exhibition items and fixture and fittings to persons or property. Every exhibitor is obliged to take out appropriate insurance and to pay the customary premiums (including insurance tax) in due time. Exhibitors from outside Germany are recommended to take out insurance in their home country.

GHM will not accept any consignments on behalf of exhibitors. In justified exceptional cases where it does so, it will not be liable for any losses incurred as a result of incorrect or late delivery.

### 25. Restrictions

It is not possible for the exhibitor to assert any claim for compensation against GHM if the event cannot be held as a result of force majeure, strikes, political events or for reasons for which GHM is not responsible. This will also apply if GHM is forced to evacuate the exhibition area or parts thereof on a temporary or permanent basis, or if it is forced to postpone or curtail the event. No participation fee will be payable if GHM is responsible for the reason for cancelling the event. Any claim against GHM is excluded.

### 26. Official regulations / instructions

With regard to other liability, the exhibitor undertakes to obtain adequate knowledge of all relevant legal and official regulations and provisions of the Federal Republic of Germany and to comply with these and to follow any instructions given by trade fair staff immediately.

### 27. Written form

All legal declarations made by GHM and any modification or amendments, even if verbal agreement was already reached, must be in writing. Verbal undertakings and subsidiary agreements will not be valid and binding unless confirmed in writing. This also applies to the annulment of this clause concerning the written form.

### 28. Statute of limitation

Claims on the part of the exhibitor against GHM arising from participation in the trade fair and all related legal relationships will lapse after 6 months. The period of limitation will commence at the end of the month in which the final day of the trade fair falls. This does not apply to claims arising from a wilful breach of obligation on the part of GHM.

### 29. House rules

GHM is responsible for ensuring compliance with the house rules over the entire site of the venue during setting up, for the duration of the fair and during dismantling.

### 30. Jurisdiction and place of fulfilment

It is agreed that the place of jurisdiction for any disputes arising in connection with this contractual relationship and the place of fulfilment will be Munich when the contracting parties are commercial businesspersons, legal persons governed by public law or a separate estate under public law. It is agreed that Munich will be the place of jurisdiction and place of fulfilment for any legal disputes arising in connection with this contract when the exhibitor is a tradesperson with no general place of jurisdiction in the Federal Republic of Germany. German law applies exclusively; the standards of international private law do not apply.

### 31. Data protection

As the responsible party in accordance with data protection legislation, GHM guarantees that the collection, storage, modification, transfer, blocking, deletion and use of personal data will be effected in accordance with relevant data protection regulations and other applicable legal provisions.

### 32. Miscellaneous

The exhibitor is not entitled to derive any rights from previous events or contracts with the event organiser.

The German version of the Terms of Participation is deemed to be the binding version.

### Organiser:

GHM Gesellschaft für Handwerksmessen mbH,  
**Note NEW: Paul-Wassermann-Str. 5**, 81829 Munich, Germany  
P.O. Box 82 03 55, 81803 Munich, Germany  
P +49 89 189 149 0  
F +49 89 189 149 239  
contact@ghm.de  
www.ghm.de

VAT Reg. no.: DE 129358691



# Important information

## Amendments to GHM's Terms of Participation and excerpts from the venue's Technical Guidelines. The venue's Technical Guidelines also apply.

### 1. Technical organisation and coordination

The entire technical set up will be arranged by

Company: Koelnmesse GmbH  
Dept.: Technischer Service  
Contact: Mr Carsten Wehrmeister  
Telephone: +49 221 821 3543  
Fax: +49 221 821 3568  
E-mail: c.wehrmeister@koelnmesse.de

### 2. Exhibitor service forms

Exhibitor service forms will be available for download from the online service centre here [www.faf-messe.de](http://www.faf-messe.de)

Closing date for orders: see data on order forms

Contractual partners reserve the right to charge a fee or surcharge for late receipt of orders.

### 3. Setting up and dismantling

#### Set-up times:

Start: Thursday, 14 March 2019 till  
Monday 18 March 2019, 7:00 a.m. – 10:00 p.m.  
Tuesday 19 March 2019, 7:00 a.m. – 6:00 p.m.  
End: Tuesday 19 March 2019, 7:00 a.m. – 6:00 p.m.

Latest permissible set-up date: Tuesday 19 March 2019, 12:00 noon

#### Dismantling:

Start: Saturday 23 March 2019, from approx. 5:00 p.m. till  
End: Tuesday 26 March 2019, midnight

**GHM reserves the right to issue passes for setting up and dismantling.**

Project management must be given advance notice when the start of setting up is delayed past midday on 19 March 2019. Early set-up on 12/13 March 2019 will incur an extra cost and is only possible in exceptional cases and with the organiser's written consent. If the dismantling period is exceeded, GHM is entitled to have the stand superstructures removed and stored at the exhibitor's cost and risk. The original condition must be restored after dismantling. The exhibitor must compensate GHM for any damage caused by improper handling.

### 4. Exhibitor passes

Exhibitor passes will be available from the online service center at [www.faf-messe.de](http://www.faf-messe.de) after the participation invoice has been paid in full. Their use is reserved solely for stand staff; it is forbidden to pass them on to third parties or to sell them. They will be blocked in the event of abuse.

### 5. Permits/stand operation

With regard to the operation of the stand, we wish to point out the permit requirements listed in the Koelnmesse Technical Guidelines.

Solvent-based paints and all aerosol cans may only be exhibited as dummy items. Buckets containing water-based paints must remain sealed and may not be opened.

Evening events are subject to approval by GHM.

Any waste generated by the exhibitor will be disposed of at the exhibitor's expense. The exhibitor must arrange and supervise the disposal of waste.

### 6. Stand approval

The Technical Guidelines, especially Part 4ff, will apply. Approval for stand structures higher than 3 m, stand areas greater than 100 square metres and covered or two-storey stands must be obtained at least 6 weeks prior to the start of setting up.

Work on setting up the stand may only commence after the exhibitor has received a copy of the plans containing notice of approval by Koelnmesse. This notice of approval does not release the exhibitor from compliance with relevant regulations. It merely indicates that Koelnmesse has no objections with regard to the design of the stand. The exhibitor will be obliged to present any additionally requested information concerning the trade fair stand immediately at the demand of Koelnmesse. Koelnmesse is not required to monitor compliance with other regulations.

Nevertheless, should Koelnmesse discover an infringement of relevant regulations, it may for this reason refuse to issue the notice of approval. We wish to advise that in special cases the construction documents may have to be presented to relevant bodies for inspection – on your behalf and at your expense. Irrespective of official construction approval, objections brought by Koelnmesse concerning shortcomings relating to the stand must be resolved immediately. In the event of impending danger, Koelnmesse may, at its own discretion, determine what measures need to be taken and have them performed at the exhibitor's expense.

### 7. Stand design

Planning and design of the stand must be adapted to the type of stand rented (island, end, corner or row stand). The stand boundaries must in no circumstances exceed the allocated stand space.

Stand walls exceeding 3 metres in height and facing neighbouring stands must be kept plain white, must be clean and must be free of text and images.

An open stand design should be ensured. This means that closed walls may be installed around the stand edges (including up to 1.50 metres of indentation) provided that these do not take up more than 70% of each side of the stand. The maximum permitted length for a continuous closed wall is 6 metres. A closed wall of a maximum of 6 metres must be followed by an opening of at least 2 metres.

The exhibitor undertakes to erect walls on all closed sides of the stand and to install floor covering. The rear sides of the stand must be kept plain white and clean by the person to whose stand they belong.

The exhibitor must take the character and appearance of the trade fair into account. In this regard, GHM is authorised to make changes to the design of the stand.

### 8. Hazard assessment of the fair stand

Each exhibitor is obliged to perform a hazard assessment of its fair stand in accordance with current occupational safety legislation and relevant accident prevention regulations, taking into consideration the Terms of Participation and Technical Guidelines of Koelnmesse as well as the Special Construction Regulations (SBauVO) of the German state of North Rhine-Westphalia, and to undertake all measures to protect the individuals at the stand. A risk assessment document must be presented on demand.

### 9. Responsibility

The construction and design of the stand must comply with all regulations applicable in Germany (in particular Special Construction Regulations, DIN or EN regulations, VDE standards and the regulations of the employers' accident insurance association in their respective valid version). All of these regulations shall apply to company-internal as well as independent stand builders, decorators and signwriters as well as to all individuals acting on behalf of exhibitors or for their account in relation to the construction and design of the stand. The exhibitor shall be responsible for ensuring compliance with all regulations. Set-up personnel and other individuals acting on behalf must be monitored to ensure their compliance with the regulations. The provisions of the General Part of the Terms of Participation and Technical Guidelines remain unaffected.

### 10. Maximum heights for stand structure and advertising

The maximum height for structures is 7.50 metres. The maximum height for advertising is 7.50 metres. Written permission must be obtained from the neighbouring exhibitor for stand structures and advertising over 4 metres in height, or a distance of 2 metres to the neighbouring stand must be observed.

Stand walls exceeding 3 metres in height and facing neighbouring stands must be kept plain white, must be clean and must be free of text and images.

### 11. Driving, transport and parking

Motor vehicles may only enter fair halls for loading and unloading after permission has been given by trade fair staff on site. Written consent must be obtained from GHM in good time for special loads. The provisions of the German Road Traffic Regulations (StVO) apply when driving on the trade fair site. Lorries exceeding 3.5 tons may not be parked in the parking areas during the trade fair. GHM may have any unauthorised parked vehicles removed at the vehicle owner's expense.

### 12. Technical fittings

All technical devices, equipment and fixtures must comply with VDE regulations and locally applicable provisions. Electrical fixtures and fittings may only be installed, connected and inspected at the site of the venue by firms authorised by the venue operator.

### 13. Trade fair advertising spaces

Advertising spaces located on the venue site are rented out to exhibitors exclusively and directly by the venue organiser.

### 14. MyBusiness premium allowance

The MyBusiness premium allowance costs € 10.50 per square metre of occupied stand area.

It includes the following services:

- Online ticket coupons for your customer invitations
- Data about your registered visitors
- Self-adhesive stickers (to order)
- Visitor leaflets (to order)
- Trade fair guide (to order)



**15. Trade fair end**

The trade fair finishes at 05.00 p.m. on 23. March 2019.

The stand must be duly occupied until the official end of the trade fair. A penalty of € 2,000.00 will be due on each breach of this provision.

**Organiser:**

GHM Gesellschaft für Handwerksmessen mbH,  
**Note NEW: Paul-Wassermann-Str. 5**, 81829 Munich, Germany  
P.O. Box 82 03 55, 81803 Munich, Germany  
P +49 89 189 149 0  
F +49 89 189 149 239  
contact@ghm.de  
www.ghm.de

VAT Reg. no.: DE 129358691



*Your Fair Partner*

**GHM Gesellschaft für  
Handwerksmessen mbH**

P.O. Box 82 03 55  
81803 Munich, Germany  
Willy-Brandt-Allee 1  
81829 Munich, Germany

**Note NEW:**  
**Paul-Wassermann-Str. 5**,  
81829 Munich, Germany

P +49 89 189 149 0  
F +49 89 189 149 239

kontakt@ghm.de  
www.ghm.de